

Control Power Transformers

CU4, CU5

Low-voltage control power transformers

■ Features

- Conformance to EN standards (EN61558-2-4:1997, EN61558-1:1997+A1) certified by TÜV
- Wide line-up includes 12 single-phase types, from 100VA to 5kVA, and 7 3-phase types, from 5kVA to 30kVA

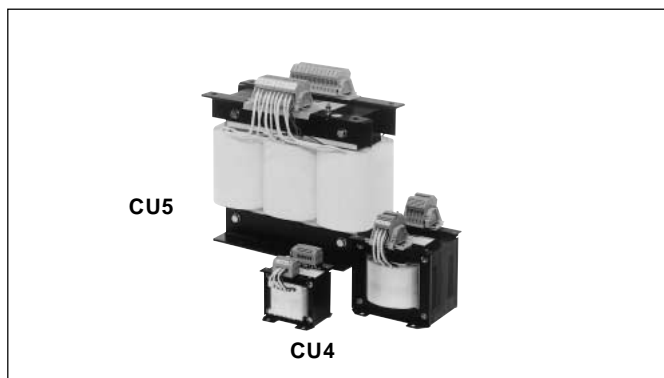

■ Specifications

Type	Single-phase transformer CU4	3-phase transformer CU5
Capacity	100VA, 150VA, 200VA, 300VA, 500VA, 750VA 1kVA, 1.5kVA, 2kVA, 3kVA, 4kVA, 5kVA	5kVA, 7.5kVA, 10kVA, 15kVA, 20kVA, 25kVA, 30kVA
Frequency	50/60Hz	50/60Hz
Primary voltage	200/220/230/240V	380/400/415/440V
Secondary voltage	100/110V	200/220V
Insulation class	100 to 200VA E Class 300 to 3kVA B Class 4kVA, 5kVA H Class	H Class
Degree of protection	IP20	IP20
Shield	Electrostatic shield	Electrostatic shield
Connection and terminal layout		$\Delta - \Delta$ Yd1

■ Type number nomenclature

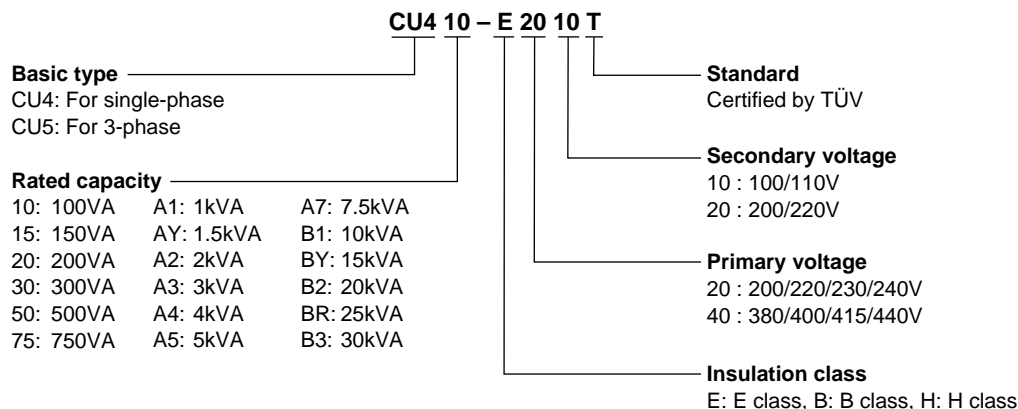

■ Ordering information

Specify the following:

1. Type number

■ Type and ratings

Single-phase Primary voltage: 200/220/230/240, Secondary voltage: 100/110V

Type	Rated capacity	Insulation class	Dimensions (mm)								Terminal diameter (mm)		Mass (kg)
			Fig. No.	A	D	E	F	X	H	J	Grounding	Others	
CU410-E2010T	100VA	E	Fig. 1	90	62	68	85	120	110	4.5×9	4	3	2.2
CU415-E2010T	150VA	E		100	69	84	105	130	115	4.5×9	4	3	3.2
CU420-E2010T	200VA	E		100	69	90	110	135	115	4.5×9	4	3	3.6
CU430-B2010T	300VA	B		135	88	70	90	120	150	6×10	4	3	5.3
CU450-B2010T	500VA	B		135	88	110	130	180	180	6×10	4	3	9.2
CU475-B2010T	750VA	B		160	110	109	140	180	195	8×12	4	4	12
CU4A1-B2010T	1kVA	B		160	110	119	150	190	195	8×12	4	4	14
CU4AY-B2010T	1.5kVA	B		185	115	116	150	190	220	8×12	4	4	19
CU4A2-B2010T	2kVA	B	185	115	144	175	210	220	8×12	4	4	24	
CU4A3-B2010T	3kVA	B	Fig. 2	230	130	160	195	260	250	8×12	5	4	39
CU4A4-H2010T	4kVA	H		250	180	170	215	300	280	10×15	5	6	47
CU4A5-H2010T	5kVA	H		250	180	180	230	310	280	10×15	5	6	51

3-phase Primary voltage: 380/400/415/440, Secondary voltage: 200/220V

Type	Rated capacity	Insulation class	Dimensions (mm)								Terminal diameter (mm)		Mass (kg)
			Fig. No.	A	D	E	F	X	H	J	Grounding	Others	
CU5A5-H4020T	5kVA	H	Fig. 3	330	160	138	166	210	330	10×15	5	4	46
CU5A7-H4020T	7.5kVA	H		400	200	146	174	250	380	10×15	5	4	69
CU5B1-H4020T	10kVA	H	Fig. 4	400	200	161	189	280	400	10×15	5	6	83
CU5BY-H4020T	15kVA	H		450	200	198	230	330	440	10×18	5	6	108
CU5B2-H4020T	20kVA	H		450	200	208	240	340	440	12×18	6	6	119
CU5BR-H4020T	25kVA	H		500	300	200	240	350	480	14×21	6	6	143
CU5B3-H4020T	30kVA	H		500	300	220	260	390	480	14×21	6	6	167

■ Dimensions, mm

Fig. 1

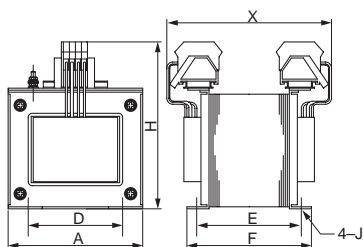

Fig. 2

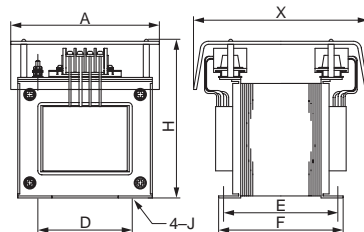

Fig. 3

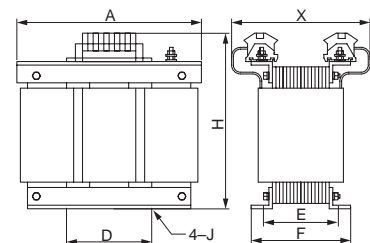
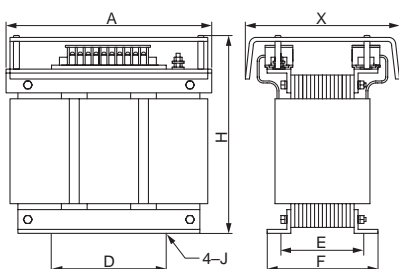

Fig. 4



Control Power Transformers

CU4, CU5

UL approved

UL506 and UL1446 approved low-voltage control power transformers

■ Features

- Approval for UL506 (Specialty Transformer) and UL1446 (System of Insulating Materials — General)
UL506: File No. E243896
UL1446: File No. E243895
- All products have UL, c-UL, and CE marking.
- A wide product range is available.

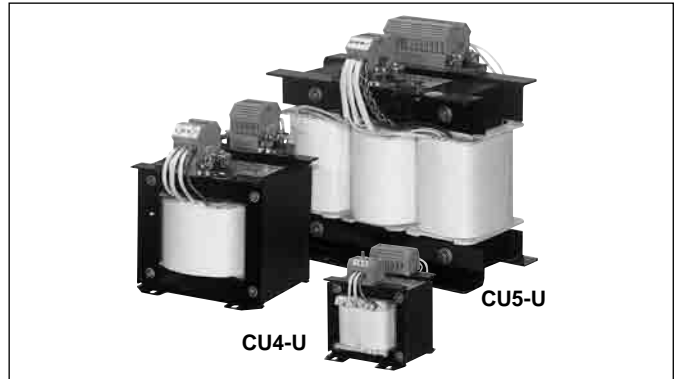

■ Specifications

Type	Single-phase transformer CU4-U	3-phase transformer CU5-U
Capacity	100VA, 200VA, 300VA, 500VA, 750VA 1kVA, 1.5kVA, 2kVA, 3kVA, 5kVA	5kVA, 7.5kVA, 10kVA, 15kVA, 20kVA, 25kVA, 30kVA
Frequency	50/60Hz	50/60Hz
Primary voltage	200/210/220/230/240V 380/400/415/440/460/480V	200/208/220/230/240V 380/400/415/440/460/480V
Secondary voltage	100/110/115/120V 200/208/220/230/240V	200/220V
Insulation class	100 to 200VA A Class 300VA to 3kVA B Class 5kVA H Class	H Class
Degree of protection	IP00	IP00
Shield	Electrostatic shield	Electrostatic shield
Connection and terminal layout		

■ Type number nomenclature

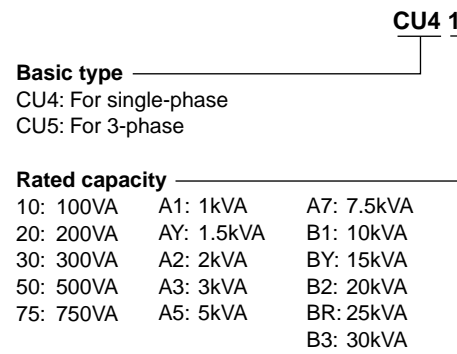

■ Ordering information

Specify the following:
1. Type number

Standard
UL approved

Secondary voltage
10 : 100V system (Refer to the above specifications)
20 : 200V system (Refer to the above specifications)

Primary voltage
20 : 200V system (Refer to the above specifications)
40 : 400V system (Refer to the above specifications)

Insulation class
A: A class, B: B class, H: H class

■ Type and ratings

Single-phase

Type	Rated capacity	Insulation class	Dimensions (mm)							Terminal diameter (mm)		Mass (kg)
			Fig.	A	D	E	X	H	Mounting hole J	Grounding	Others	
CU410-A 2010U	100VA	A	Fig. 1	90	62	68	120	120	4.5 x 9	4	3	2.2
CU420-A 2010U	200VA	A		100	69	90	135	125	4.5 x 9	4	3	3.6
CU430-B 2010U	300VA	B		135	88	70	120	160	6 x 10	4	3	5.3
CU450-B 2010U	500VA	B		135	88	110	180	180	6 x 10	4	3	9.2
CU475-B 2010U	750VA	B		160	110	109	180	195	8 x 12	4	4	12
CU4A1-B 2010U	1kVA	B		160	110	119	190	195	8 x 12	4	4	14
CU4AY-B 2010U	1.5kVA	B		185	115	116	190	220	8 x 12	4	4	19
CU4A2-B 2010U	2kVA	B	185	115	144	230	220	8 x 12	4	4	24	
CU4A3-B 2010U	3kVA	B	Fig. 2	230	130	160	260	260	8 x 12	5	4	39
CU4A5-H 2010U	5kVA	H		250	180	180	310	290	10 x 15	5	6	51

3-phase

Type	Rated capacity	Insulation class	Dimensions (mm)							Terminal diameter (mm)		Mass (kg)
			Fig.	A	D	E	X	H	Mounting hole J	Grounding	Others	
CU5A5-H 4020U	5kVA	H	Fig. 3	330	160	138	210	330	10 x 15	5	4	46
CU5A7-H 4020U	7.5kVA	H		400	200	146	250	380	10 x 15	5	4	69
CU5B1-H 4020U	10kVA	H	Fig. 4	400	200	161	280	400	10 x 15	5	6	83
CU5BY-H 4020U	15kVA	H		450	200	198	330	450	12 x 18	5	6	108
CU5B2-H 4020U	20kVA	H		450	200	208	340	450	12 x 18	6	6	119
CU5BR-H 4020U	25kVA	H		500	300	200	350	490	14 x 21	6	6	143
CU5B3-H 4020U	30kVA	H		500	300	220	390	490	14 x 21	6	6	167

■ Dimensions, mm

Fig. 1

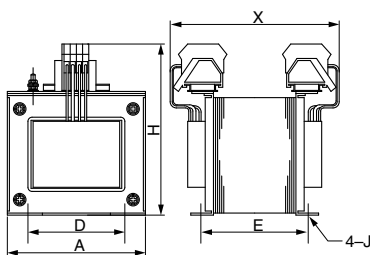

Fig. 2

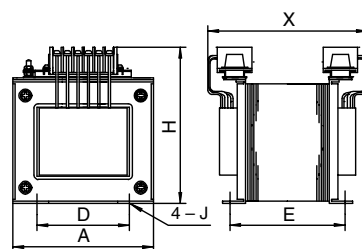

Fig. 3

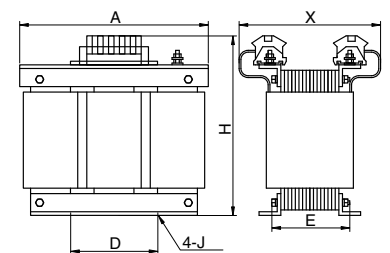

Fig. 4

